

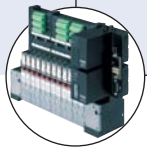

## 5/2-way Flipper Solenoid Valve for pneumatics

- Compact design
- Single and manifold mounting
- Low power consumption
- Fast response times

Type 6525 can be combined with...



**Type 8640**  
Valve island



**Type 2031**  
Diaphragm valve

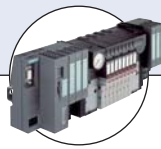

**Type 8644**  
Valve island

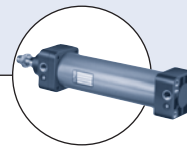

**Type 0044**  
Pneumatic cylinder

The Type 6525 consist of a pilot flipper valve Type 6144 and a pneumatic seat valve. The flipper principle allows switching of high pressures together with low power consumption and fast response times. All valves are equipped with manual override as a standard.

Technical data	
<b>Orifice</b>	DN 4.0
<b>Body material</b>	PPS, PA
<b>Seal material</b>	FKM, NBR and PUR
<b>Media</b>	Lubricated, oilfree, dry compressed air; neutral gases (5µm filter recommended)
<b>Media temperature</b>	-10 bis +50 °C
<b>Ambient temperature</b>	-10 bis +55 °C
<b>Manual override</b>	Standard
<b>Port connection</b>	Flange for MP11
<b>Pneumatic module</b>	Type MP11 with M5, M7, push-in connection Ø 6 mm
<b>Voltage tolerance</b>	±10%
<b>Cycling rate</b>	approx. 1000 c.p.m.
<b>Voltage</b>	24 V DC *
<b>Nominal power</b>	0.8 W
<b>Duty cycle</b>	Continuous operation (100% ED)
<b>Electrical connection on valve</b>	Rectangular plug with Raster 5.08 mm
<b>Type of protection</b>	IP 40 with rectangular plug
<b>Protection class</b>	3 acc. to VDE 0580
<b>Weight</b>	21 g
<b>Mounting</b>	with 2 screws M2x20
<b>Installation</b>	As required, preferably with actuator upright
<b>Response times [ms]</b>	Measurement acc. to ISO 12238
Opening	<10ms
Closing	<10ms

\* 10% residual ripple allowed

## Ordering chart for valves

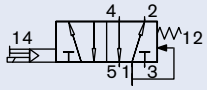
Circuit function	Orifice [mm]	Q <sub>Nn</sub> value air [l/min] <sup>2)</sup>	Pressure range [bar] <sup>3)</sup>	Response times		Voltage/ Frequency [V/Hz]	Item no.
				Opening [ms]	Closing [ms]		
<b>H</b> 5/2-way valve 	4	300	1-10 <sup>1)</sup>	<10	<10	24V/DC *	186 271
			2.5-10	<10	<10	24V/DC *	179 938

\* 10% residual ripple allowed

<sup>1)</sup> Version with auxiliary pilot air<sup>2)</sup> Measured at +20°C, 6 bar pressure at valve inlet and 1 bar pressure difference<sup>3)</sup> Measured as overpressure to the atmospheric pressure

## Ordering chart for accessories

Accessory	Version	Features	Item no.
Rectangular cable plug	Raster 5.08 mm	with 3 m cable	133 486
		with 300 mm flying leads	644 068
		with 2 single contacts	644 067
Protective cover for 5/2-way valve position	complete	for 1 unused valve position	650 373
Pneumatic connector module	left	Push-in connection Ø 10 mm	144 752
		G 1/4	144 750
		NPT 1/4	144 751
	right	Push-in connection Ø 10 mm	144 755
		G 1/4	144 753
		NPT 1/4	144 754
Pneumatic basic module MP11, 2 valve wide	Push-in connection Ø 6 mm	without check valve	144 903
		with check valve in R	144 909
		with check valve in R and S	144 906
	Connection M5	without check valve	144 904
		with check valve in R	144 910
		with check valve in R and S	144 907
	Connection M7	without check valve	144 905
		with check valve in R	144 911
		with check valve in R and S	144 908
Pneumatic basic module MP11, 8 valve wide	Push-in connection Ø 6 mm	without check valve	144 912
		with check valve in R	144 918
		with check valve in R and S	144 915
	Connection M5	without check valve	144 913
		with check valve in R	144 919
		with check valve in R and S	144 916
	Connection M7	without check valve	144 914
		with check valve in R	144 920
		with check valve in R and S	144 917

**Dimensions [mm]**

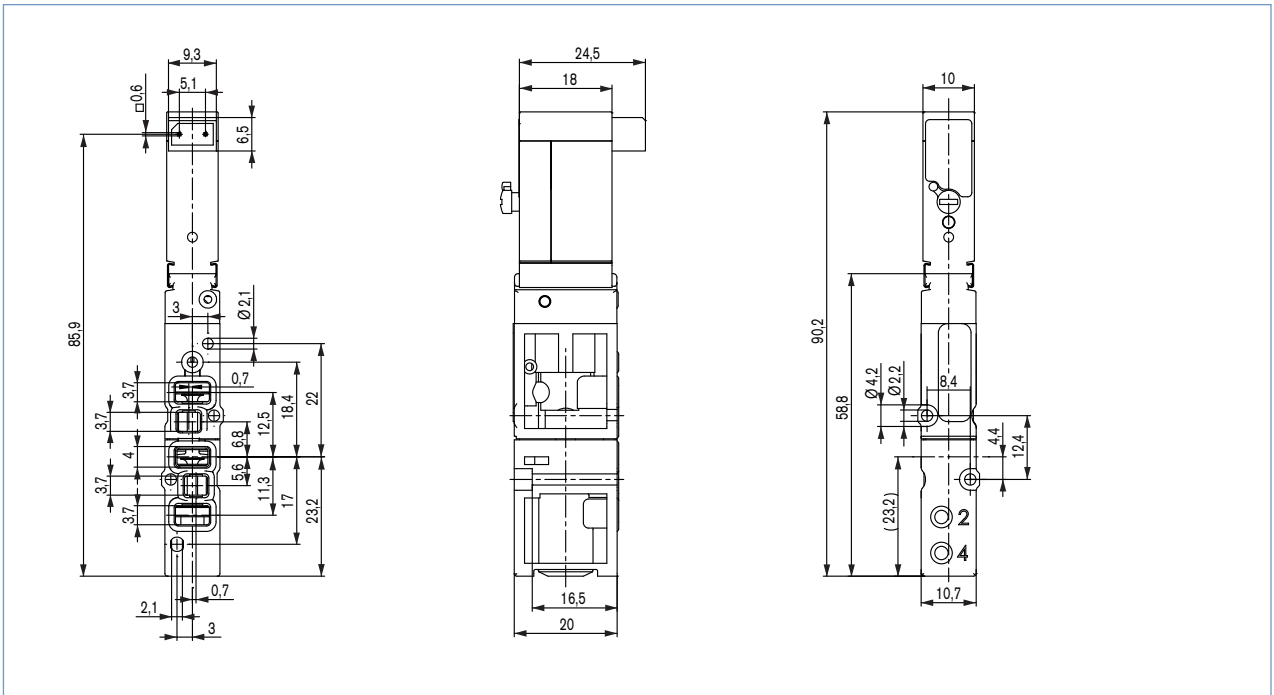

**Selectional drawing**

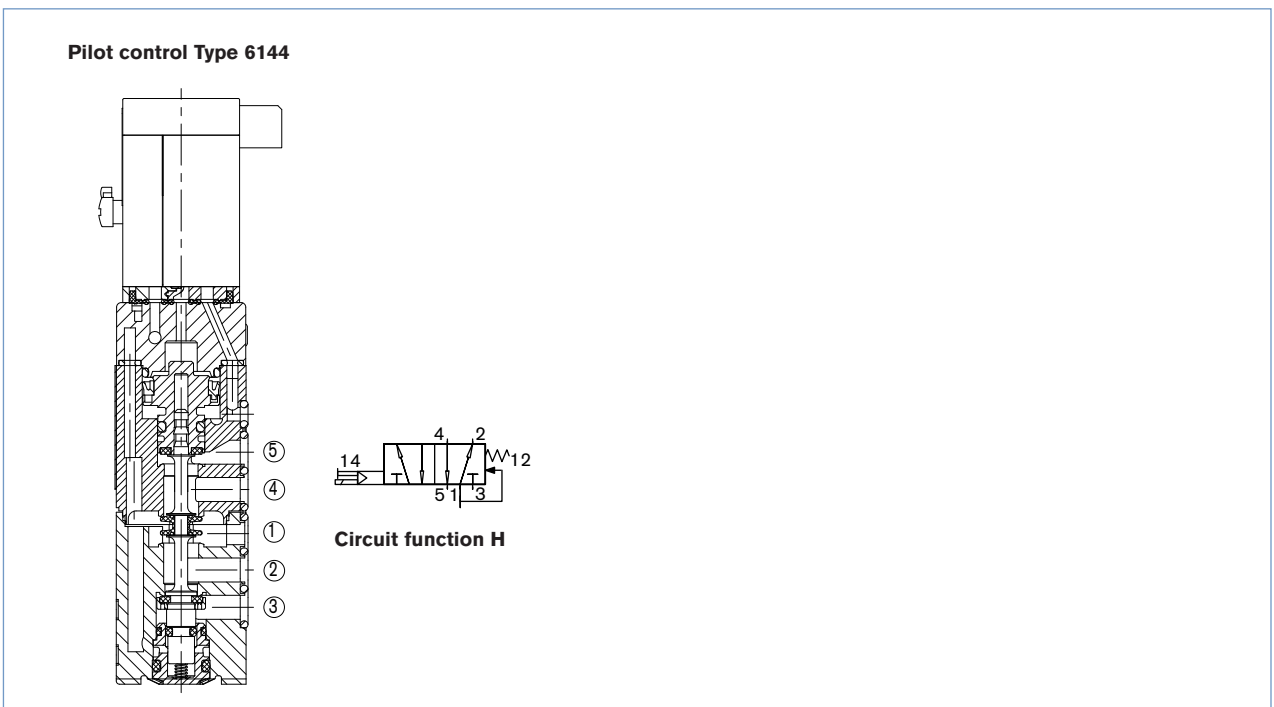

To find your nearest Bürkert facility, click on the orange box →

[www.burkert.com](http://www.burkert.com)

In case of special application conditions,  
please consult for advice

We reserve the right to make technical changes without notice  
© Christian Bürkert GmbH & Co. KG

1405/5\_EU-en\_00891920